

Providing Care and Meeting Challenges Through
Relentless Compassion

2021
Report to
Donors



EveryStep 

Care & Support Services | Home Care | Hospice
Interpretation | Community Health | Grief & Loss Services

OUR MISSION

We empower
individuals,
support families
and strengthen
communities.



EveryStep's work has not wavered since the pandemic began so many months ago. Through relentless compassion, we continue to provide care and support to Iowans facing life's most difficult moments — whether it's support for young moms; assistance to immigrants and refugees navigating a new country; wellness services to our communities; in-home care for those who are ill, injured or facing the end of life; or compassionate support to families during times of grief and loss.

Despite the ongoing challenges that COVID-19 presented, EveryStep enjoyed many successes during the past fiscal year. For example:

- We successfully completed our \$3.5 million capital campaign to renovate EveryStep's Kavanagh House. Construction began in the spring, and work will be completed in January 2022. During the renovations, we provided hospice house services at EveryStep's Bright Kavanagh Center location in east Des Moines, ensuring continuity of care throughout the project. Many thanks to George and Deb Milligan, for chairing this campaign, and to all of our donors (p. 15) who made the renovations a reality.
- Our EveryStep Palliative Care program expanded through a new collaboration with Greater Regional Health Visiting Physicians Clinic in Creston. This vital and growing service, which served 50 patients last year, is now offered in Creston and at Madison County Memorial Hospital Specialty Clinic in Winterset.
- In late 2020, EveryStep Grief & Loss Services' Amanda the Panda program wrapped, packed and delivered more than 550 Cheer Boxes to families who were experiencing their first holiday season after the loss of a loved one — an increase of more than 100 boxes over the prior year.
- We created a new Volunteer Management department and online portal to manage, support and communicate with EveryStep's 600+ volunteers.
- As EveryStep continues its Diversity, Equity and Inclusion journey, our DEI committee identified and implemented a new learning platform which offers employees relevant, engaging and educational resources, videos and podcasts. The DEI committee also developed an 18-month activity and communication workplan.

EveryStep was able to achieve this success thanks to the ongoing, generous support of our donors and funders. We are grateful for your investment in EveryStep and the work that we are privileged to provide to those who need our services.



A handwritten signature in black ink that reads "Tray Wade".

Tray Wade
President & CEO



A handwritten signature in black ink that reads "Bill Warner".

Bill Warner
Chair, Board of Trustees



A handwritten signature in black ink that reads "Pat Barry".

Pat Barry
Chair, Board of Directors

30+ PROGRAMS



Hospice



Home Care



Nurse-Family Partnership

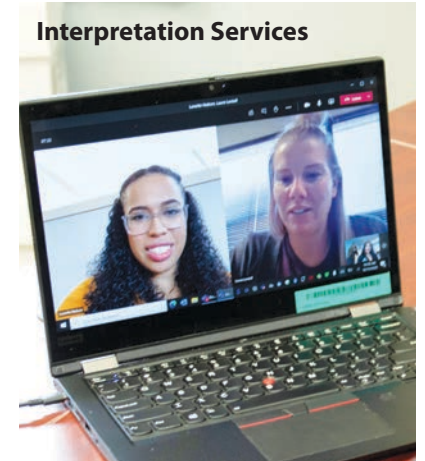

Children at Home



I-Smile™



Senior Companion

SERVING MORE THAN 59,000 IOWANS

EVERYSTEP PROGRAMS

1st Five - Healthy Mental Development
5-2-1-0
Adopt-A-Family
Amanda the Panda
Biometric & Wellness Screenings
Care for Kids - EPSDT
Child Care Nurse Consultant (CCNC) Program
Correctly Compliant Program
Children at Home
Community Home Visitation
Connections
Contract RN
Correctional Facilities 5th Judicial
DNA Collection
Drake University Head Start Nurse Consultation
FathersMatter
Flu Vaccination Clinics
Grief & Loss Services
Healthy Homes Iowa
Healthy Start & Empowerment
Home Care
Hospice
Interpretation
Refugee Immigrant Guide Program
Iowa Family Support Network
I-Smile™/Dental Voucher
Maternal Child Health Outreach
Nine2Thrive™
Nurse Family Partnership
Palliative Care
Play & Learn
Senior Companion
Senior Health
Stork's Nest/Family Nest
StoryBook Project



Parent and child learning activities



Amanda the Panda/Cheer Box



Flu vaccinations

Rising to the Challenge

Despite the ongoing challenges of the pandemic, EveryStep was able to meet, and often exceed goals this past fiscal year. A few highlights include:

2,677 hospice and home care patients were served across 45 counties.

92% of hospice patients would recommend EveryStep compared to national average of 85%.

1,232 children and pregnant women received dental screenings, oral health education and referrals to providers for dental concerns.

EveryStep's Senior Companions drove 14,484 miles

to deliver groceries and supplies to **258** homebound seniors, helping them stay safe and maintain their independence in the comfort of home.

551 Cheer Boxes were delivered to grieving families during the 2020 holiday season.

1,307 children and families received grief support through Amanda the Panda, including online support groups and virtual camps.

100% of babies* born into EveryStep's Community Home Visitation program were at a healthy birth weight.

1,241 Stork's Nest and Family Nest participants earned points toward more than **\$46,000** in baby items and household goods.

Our Children at Home program helped 393 families secure more than **\$518,000** in services and special equipment for their children with disabilities.

590 Volunteers helped support our staff, patients and clients.

993 remote interpretation sessions took place to help bridge language barriers.

6,959 phone visits were made with participants in our Healthy Start & Empowerment Project. This was in addition to **117** face-to-face visits and **86** virtual visits.

294 childcare providers received education and support, including COVID-19 guidance, from our team of Child Care Nurse Consultants.

59,907 Iowans were touched by our services last year.

**Does not include twins or other multiple births*

Events

EveryStep's Art of Compassion Celebration

With a theme of "Compassion Starts at Home," EveryStep's signature annual fundraiser took place at 30 different central Iowa house parties on October 8, 2020, raising more than \$160,000 for EveryStep's programs and services.

PRESENTING SPONSORS
Mary Kay & Douglas G Bruce
Jen Stanbrough Real Estate

Instead of gathering at an event center filled with 400 people, most of the loyal supporters and friends found themselves seated safely in homes and work settings for the 2020 Art of Compassion. Whether parties were indoors or outdoors, casual or formal, guests listened to a recorded program, bid online for more than 40 silent auction items, participated in wine and beer raffles, and donated funds to provide holiday Cheer Boxes, quality of life wishes and Stork's Nest baby supplies.

Art of Compassion will be back in person on April 26, 2022 at Glen Oaks



EveryStep's Amazing FundRacer

More than 20 teams competed on May 15, 2021 in a trek around Des Moines, raising more than \$23,000 to support at-risk and low-income children and families served by EveryStep. In this inaugural event, EveryStep's Amazing FundRacer, teams of two and four deciphered clues to reach destinations throughout the city where they completed mental and physical challenges that related to EveryStep's maternal and child health programs. The need to be outside and safely distance during the COVID-19 outbreak led to this exciting, new event. **With overwhelming positive feedback, it is once again on the calendar and scheduled for May 14, 2022.**

PRESENTING SPONSOR
F&G Annuities & Life

COMMUNITY SPONSOR
Jen Stanbrough Real Estate



EveryStep's Good Grief Golf Outing

Golfers generated more than \$39,000 for the programs of EveryStep Grief & Loss Services at Echo Valley Country Club in Norwalk on June 17, 2021. Funds raised at the fifth annual Good Grief Golf Outing support the no-cost bereavement support groups conducted by our bereavement counselors throughout 44 southern and central Iowa counties and to our Amanda the Panda programs for activities with children, families and individual adults as they experience hope and healing during times of grief and loss.

PRINCIPAL SPONSORS
Mary Kay & Douglas G Bruce
Merchants Bonding Company

The next outing is scheduled for June 14, 2022.



Donald Buddenhagen's Trip Back Home: *an EveryStep story of care, compassion and coordination*

An Iowan for the last 20 years, Donald Buddenhagen has strong family ties to Spruceton Valley in the Catskills of New York state, so much so that he named his son Spruceton to honor his heritage. When Donald was diagnosed with a rare and untreatable form of stomach cancer in May of 2021, he badly wanted to return there while he still could. "Given a limited life span, I wanted to see family and friends before I pass," said Donald.

The EveryStep Hospice team in Mount Ayr became involved when Donald's sister and caregiver Bonnie reached out for help with her brother's pain level.

"[EveryStep medical director] Dr. Mouser came to Leon to meet with Donald and me at his home," said Misha Curtis, EveryStep Hospice team director and palliative care director at EveryStep's Greater Regional Hospice Home in Creston. "I arrived a little early, went in and introduced myself and just really had a heart-to-heart regarding goals of care and, actually, his goals of life." That's when Misha learned of his wish to travel to Spruceton Valley.

After the visit, Donald began receiving the many services EveryStep Hospice provides, including enhanced pain control methods. By this time, Bonnie had already started planning the trip to New York. When Misha told Bonnie and Donald that the EveryStep Foundation has a Quality of Life fund that provides financial assistance for final wishes, they were both surprised. "We looked at each other and said 'well, I didn't know that!'" said Bonnie.



Gifts to EveryStep Foundation fund final wishes for hospice patients and ensure they can find quality of life — because every moment matters.

Because Donald received total parenteral nutrition (TPN), an intravenous form of nutrition feeding, arrangements had to be made for the therapy to continue during his trip. Misha went to work and secured a travel contract with a New York hospice provider. Donations to EveryStep Foundation's Quality of Life Fund paid for the substantial cost of overnight shipment of the TPN to that hospice.

With everything in place, Donald traveled to Spruceton Valley with his sister and two children, Spruceton and Isabella. They drove across the country in a Chrysler 300, the exact car Donald had requested for his journey. His two-week stay included lots of catching up with friends and family. "I had groups of cousins who hadn't seen each other in 20 years, and friends who hadn't seen each other in 30 years. Because they were there to see me, everybody else got together too. That was really a neat thing," said Donald.

Donald was also able to visit the 200-year-old cemetery where his mother, grandparents, aunts, uncles and other ancestors are buried. Donald's ashes will go there too.

"The fact he got to do this is just monumental to me," said Bonnie. "With the EveryStep Foundation's Quality of Life fund covering the cost of the rental car, gas and hotel room, we had enough money to make cremation arrangements, which we wouldn't have been able to afford before."

"EveryStep has been wonderful to work with," said Bonnie. "We appreciate everyone involved."

"This is the absolute best part of my job," said Misha. "Getting to help fulfill those last wishes is really what matters at the end of the day. I'm so glad I can be a part of it."

To help make final wishes come true for EveryStep Hospice patients, please make a donation at everystep.org/donate.



An Unexpected Delivery: *Cheer Box comforts a grieving daughter*

It's the call no one wants to receive.

In 2018, Jennifer Baker got a phone call informing her that her dad had been killed in a car crash. "We had to leave in the middle of the night. My daughters were 4 and 2," recalls Jennifer. "My oldest daughter remembers everything. She stayed awake the whole car ride and heard all the phone calls we had to make. It was so traumatic for all of us."

As Jennifer and her family prepared to face their first holiday season without her father, they received an unexpected delivery one December evening: a Cheer Box from EveryStep Grief & Loss Services. The Cheer Box contained 12 gifts, each intended to help Jennifer and her daughters process the unique grief they were feeling during the holidays.

Each gift emphasized remembrance and comfort.

"We opened each item and read the little cards," remembers Jennifer. "We got a plate to decorate. Now it's filled with my dad's favorite sayings, recipes and song lyrics. The cozy blanket was fought over but is still on my daughter's bed. We also got a plant. I can barely keep anything green alive, but it grew into something so beautiful. This is one thing I will always remember."

Last holiday season, 225 EveryStep volunteers delivered 551 Cheer Boxes to families in Iowa and beyond.

"I'm so appreciative of the box," Jennifer says. "It gave me some tools to use to help my young daughters process their feelings and it probably helped me even more."

"These small items were and continue to be special, positive reminders of my dad and I'm so grateful. I truly do think each item in the box generates a positive grieving memory and I think it would be a powerful tool to help other families through difficult times after the loss of a loved one."



Find free educational resources, support group details and Cheer Box information at everystep.org/services/grief-loss

Donations to EveryStep Foundation fund the Cheer Box program and the many other free grief support services offered by EveryStep's Amanda the Panda and hospice programs.

Helping a Family Grow: *Reginalda's story*

Reginalda was a single mother with a 15-year-old, an 11-year-old and a baby on the way. It had been more than a decade since she had last given birth, so she contacted EveryStep because she needed current baby items and developmental information.

EveryStep community health specialist Berenice Reyes began working with Reginalda. Because Spanish is Berenice's second language, she was able to easily converse and build trust with Reginalda, a native Spanish speaker. Berenice connected Reginalda with EveryStep's supportive services for pregnant women and young children, including home visits; prenatal, postpartum and parenting education; screenings for child development and prenatal depression; support groups and help with accessing community resources.

"Besides my home visits, I introduced Reginalda to EveryStep's Stork's Nest," said Berenice.

EveryStep's Stork's Nest is an educational incentive program. Participants earn points for healthy behaviors such as keeping medical appointments, WIC participation, breastfeeding and school attendance. The points are redeemed at the Stork's Nest store for needed baby items such as diapers, clothing, strollers, cribs and car seats.

"The program has helped me because I have received information about my pregnancy, my baby and resources around the community," said Reginalda. "[Berenice] is very kind and understands my needs, and always has my questions answered. I feel very happy with the program."

"Reginalda always follows through with visits and applies suggestions I give her," said Berenice, who praised Reginalda's initiative. "She has expressed many times how helpful our program has been for her and her family."

Help us stock the Stork's Nest! Shop at smile.amazon.com, select EveryStep as your designated charity, and Amazon will donate to EveryStep — at no cost to you!



Donations to EveryStep Foundation purchase vital baby supplies for EveryStep's Stork's Nest program and the families it serves.

Caring Legacy

The following people represent a group of visionary, forward-thinking supporters who have made estate-plan provisions to give a lasting gift to EveryStep's programs.

Anonymous

Margaret Brennan
Thomas Burkhardt
Barbara Colter
Tom and Karen Conley
Larry Epps
Suzie Glazer Burt
Kevin and Laurie Dowd Gowdy
Mary and Doug Hedberg
A. Jane Jennings
Patrice Maurer
Jan Miller Straub
Marilyn J. Musser
Imogene M. Nuding
Evelyn Schiller
Pam and Chuck Schoffner
Lyle and Jan Simpson
Judy Singer
Jane and Stan Sondall
Nancy Stefani
Dale and Kadi Wakelin
Freida Wallace
Lenora and Gary Waller
Wanda Wendt
Fred Werner
Thomas Zucker

Thank You, Donors

Thank you to the following individuals, organization and foundations that made annual gifts to EveryStep totaling \$250 or more during the July 1, 2020 – June 30, 2020 fiscal year. Gifts to the capital campaign to renovate EveryStep's Kavanagh House on 56th Street can be found on page 15.

\$100,000+

Blank Children's Hospital
Corporation of National &
Community Service
Larry Epps Estate
Health Resources & Services
Administration
Iowa Department of Public Health
Polk County – Early Childhood Iowa
United Way of Central Iowa

\$50,000 - \$99,999

Don and Margo Blumenthal
Mary Kay and Douglas G Bruce
Dean and Sandra Carlson
Iowa Department on Aging
Polk County Community &
Family Youth Services
Polk County Decategorization
Polk County Housing Trust
Variety The Children's Charity

\$20,000 - \$49,999

4R Kids – Early Childhood Iowa
James L. and Beth Andersen
Carlson Family Foundation
Clinton/Jackson Early Childhood
Fred Maytag Family Foundation
Jen Stanbrough Real Estate
New York Life Insurance Co.
Imogene M. Nuding Estate
Pam and Dan Sargent
Evelyn J. Schiller

Lynhon N. Stout
The Weathertop Foundation

\$5,000 - \$19,999

Advanced Problem Solutions
Bill Benskin
Betty H. Bleckley Charitable Trust
Suzie Glazer Burt
Graham J. Cook and
Catherine C. Bennett
Doris Crouch
Delta Dental of Iowa
Emily Anne Weikert Charitable
Foundation
Jeff Farner
FBL Financial Group, Inc.
Fidelity & Guaranty Business Services
Fieldstead and Company
Janice Fitzpatrick
Graham Construction Company
Kemalyn and Edward Green
Craig Hansen and
Judy Ralston-Hansen
Homesteaders Life Company
Hy-Vee, Inc.
Iowa Chronic Care Consortium
Diane and Dan Jespersen
Elizabeth John
Irene McFerron
Merchants Bonding Company
Judith Milligan
The Molina Healthcare Charitable
Foundation
Morgan E Cline Foundation

MTC Hospitality Group
Colleen Peterson
Sammons Financial Group
Scheels
Darrell Schenk
Pam and Chuck Schoffner
SHAZAM
SHYFT Collective
Julie and Thomas Swank
UnityPoint Health
Pete and Mary Sue Vorbrich
Voya Financial
Tray and Stacey Wade
West Bank
Kim and Rich Willis
Warren Wilson

\$1,000 - \$4,999

Access Systems
Katie and Jeremy Adams
Kerry and Denise Adaway
Affinity Credit Union
Mike Albert
Stephanie and Jake Albrecht
Deborah and Jerome Antel
Denise and Tom Arnold
Jane and Kip Augspurger
Elizabeth Baker
Baker Group
Mollie and Britt Baker
Bankers Trust
Patricia Barry and Bryan Hall
Barton Solvents, Inc.
Beasley Family Foundation Inc.

Chris Benda
Bible Faith Church
BKD CPAs & Advisors
Teri and Paul Bognanno
Nancy Boostrom
Michelle Boris
Braun Family Foundation
Daniel Brennan
Joseph S. Brick
Dave and Cindy Bridgewater
Mary C. Brooks
Bryan and Elizabeth Burkhardt
Kelly Caldbeck and Ted Thoms
Debbie Carr
Casey's General Stores, Inc.
Jeff and Rhonda Cash
David and Rhonda Castagna
Central Bank
City of Des Moines Employees
Community State Bank
Concepts Cares Foundation
Martha Cox
Jane and T.J. Craver
Bill Crittenden
Crown's Club
Ashley and James Culp
Dallas County Agricultural
Jaclyn Daniels
Davis Equipment Corporation
Basil and Linda Dawson
Sharon Dee
Vera Denney
Dentons Davis Brown Law Firm
Des Moines Business Group

Des Moines Elks #98 BPOE
Des Moines University
Elite Pools
Equitrust Life Insurance
Company
Rebecca and James Ervin
Farm Bureau Wealth
Management
Maurice and Velda Fitzgerald
Charity Foundation
Jane and Steve Flanagan
Deniz Franke
Dr. Brian Freeman
Jay Fried
Katie and Michael Gehringer
Joyce Gelhaus
Jodi and Jake Gibson
Marcia Gibson
The Graham Group, Inc.
Grand View Lutheran Church
Great Western Bank
Ryan Greening
Jill Greiner
Lacey Grubb
Hamilton's Funeral Home, Inc.
Mark and Kristi Hasek
Carol Hauptert
Diane and Jim Hedden
Dee and Nick Henderson
Ryan Hervey
Holmes Murphy &
Associates, Inc.
Phyllis and Joe E. Hutchinson
Mark and Lori Iles
Iowa Aces 360
Janet Jackson
Ryan Jensen - USA Mortgage
Nelda Johansen
John and Ann Ghrist
Foundation
Marie Kayser
John and Lisa Kenworthy Family
Foundation
Jim and Mary Ellen Kimball
Jean Kruse

Carl D. Lee
Shery and Terry Lint
Marion County Bank
Karen Martin
Julie and Harry Matternas
Dan and Joanne McPhail
Kim Medici Shelquist and
David Shelquist
Katie Mertens
Steve Mescher
Lynn and Catherine Michl
MidAmerican Energy
Mid-Iowa Health Foundation
Midwest Family Lending
Deb and George Milligan
Linda Moeller
Ernie Morrison
Kathy and Roger Morrison
Martha Musmaker
NCMIC Group, Inc.
Kathy Nellor
William Newland
Julia Noyce
Paul and Kathleen Brown
Foundation
Donald and Gretchen Perschall
Merlin Peterson
Sharon and John Pohl
Dori and Brad Pote
QCI
Qualis Management
Kathy Reed
Helen Robinson
Charles Rohm
Jackie and Mike Rolow
Rotary Club of Des Moines A.M.
Foundation
Priscilla and David Ruhe
Kathy and Charles Safris
Steve and Renee Schaaf
Richard Schappert
Margaret Schinstock
John and Judith Ann Schneller
Craig Schrader
James Secor

Jaey and Brenda Sedlacek
Scott and Linda Shuck
Larry and Chris Sidwell
Linda and Bruce Simonton
Kendra and William Sinclair
Melissa Slater
Jane and Stan Sondall
Robert Squaires
Lory and James Stewart
Storey Kenworthy
Jan Miller Straub
Mary Stuart and David Yepsen
Richard and Bonnie Sunderland
Laura Sweet
Candice Tanner
Niky Cross Taylor and
Scott Taylor
Thomas Temple
Ashley Tessmer
Ann and Rob Torry
True Roots Chiropractic
United Way of Appanoose
County
United Way of Marion County
Catherine Van Kley
Jim and Dee Vickery
The Waldinger Corporation
Katherine and Kenneth Waller
Brian Walsh
William and Amanda Warner
Wellmark Foundation
Petra White
Sean P. Williams
Randy Winegard
Paul Witt
Jerry and Sue Woods
\$500 - \$999
Scott Anderson
Deb Angelo
Apostolic Christian Church
David and LeAnne Baccile
Ann and Jonathan Balashaitis
Karen and Kevin Baldock
Lynn Ballard

Connie Beckman
Kim and Sally Beisser
Mary Bernard
Sarah and Craig Black
Blue Compass
Betty and Jeff Bollard
Virginia Boulton
Ethan Brenizer
Robert Brooks
Kimberly and Mike Bryan
Marlene and Bob Buckley
Craig Canby
Barbara and Steve Cappaert
Jan Carmichael
Lynnette and Alan Carver
Central Iowa Power Cooperative
Sally J. Chapman
Charles Chedester
Linda and Mitch Clauson
Charlene Cobb
Combined Federal Campaign/
Northern Lights
Commonwealth Electric
Company of the Midwest
Brooke Conway
Andy Cook
Elizabeth Coonan
Tom Costanzo
Jeffrey Couch
Mary Cress
Lisa and Brad Crossett
Jake Dailey
Lori Danielson
Dale and Lori Daughenbaugh
Donald Davis
Darlene and Ronald Day
J. Dayton
Willis Deuser
Karen Dibel
Lincoln Dix
Edward and Joan Downey
Theresa Drew
David and Judy Dunn
Sally Dykes
Sally L. Ehlert

Greg Elming
Dee Epperson
Gloria Ewing
First Fleet Concerts
Donna and Craig Floro
Pattie and Patrick Fraizer
Lucinda Gannon
Joyce Godwin
Beth Goebel
Gerald and Nancy Graves
Vivian Haag
Gretchen Hageman
Gene and Beth Haigh
Renee and P.J. Hamlen
Dolores and Bernard Hannam
Ann Hanson
Brian and Elizabeth Hargrave
Nola Harper
Frosty Harrington
Linda S. Harris
Jill Havick
Chris Haviland
Gordon Hawkins
Ann Heimberger
April Hoch-Brandt
Linda Holverson
Elizabeth Houge
Donald and Cynthia Huegerich
Image Solutions
Joe Jensen
Paul and Jan Johnson
Robert Johnson
Karen E. Jones
Kathie and John Jones
Marcia and Ray Jones
Denise and Martin Junius
The Ken Eaton Foundation
Charlie and Ron Kiesling
Kinetic Edge Physical Therapy
Knights of Columbus –
St. Joseph Council 10980
Kelsey and Sean Knowles
Tammi Latham
Janet Longcor
Marc Luett

Nicole Maakestad
Millie Mandernach
Gary McBee
Cindy McCann
Romona and Allen McDanel
Kevin McGlothlin
Whitney McKinstry
Jacob McLaughlin
Miles Law Firm
Connie and John Miller
Teresa Miller
Larry Moore
Tom Nelson
Helen Norman
Wayne Norton
NuCara Home Medical
Mardelle Oakley
O'Donnell and Friends Charities
Mary Overholtzer
Toni Parkins
Pershing
Mike Phillips
Tammy Phillips
Brandy Poli
Jackie Quayle
Ojash Raval
Brenda Reed
Jeanette T. Reed
Angelia and Lloyd Robbins
Aimee and Rob Rooney
Tamara and Joseph Ross
Andy Rowland
Ron and Clarice Rubek
Marsha Rusch
Schrock Lumber Company
Marjorie Scott
Melanie and Rick Scupham
Mindy Selix
Robert Snyder
SOLD By Jason –
RE/MAX Concepts
Douglas Stamps
Ann Steger
Phillip and Amanda Stover
Heather and Jason Stuyvesant

Dr. Jon Suddarth and Dr. Julie Anderson-Suddarth
Kim Swearingin
Bret Taber
Jacqueline and Todd Tatum
Sheila Taylor
Ted Lare Design and Build
Diane Thompson
Thomas Thoms
Leann Thrapp
James and Kathryn Turner
United Way of Bergen County
Larry Vander Tuig
Lyle Veach II
Veridian Credit Union
Susan and Carl Voss
Weiler Foundation
Wells Fargo Community Support Campaign
Cathy West
Connie Westercamp
Gene White
Janice Whitehead
Michele and Steve Whitty
Joyce Williams
Windsor Heights Lutheran Church
Robert Wolfe
Annie Wood
Bruce Wood
Workspace

\$250 - \$499

Grazia Aiello
Tonya Allbee
Allen Lund Company
Amazon Smile
Dennis and Judy Annis
Jeffrey Aten
Alicia Baccam
Say Baccam
Nancy Ballew
Judy Barrington
Vivian Baxter
Angela and Mark Beary

Lula Mae Beck
Richard Beeler
Diane Benoit
Betty J. Billings
Bing's
Bi-Petro, Inc.
Lyle and Janet Blackledge Shook
Robert Blasio
Tim Blutt
Jaci Bodensteiner
Boesen the Florist
Ashley Bolsem
Michelle Book and Woody Brenton
Cindy Boyd
Julie and Richard Bright
Joleen and Randy Bunch
Steve Burger
Paul Burnside
Diane and William Caldbeck
Capital Ideas
Debbie and Michael Chenchar
Jennifer Clark
Troy and Melissa Clark
Michael Clough
Connections Breakfast Club
Patricia Cormaney
Terry Cosentino
Bonnie Criswell
Peg Daniels
Dixie Darnell
Karen Dassinger
Lindsay DeGroote
Brian and Tena DeVore
Wells and Sharon Dickson
Jody Douglas
Jonathan Duvick
Maurice Dyer
Lela Eggman
Becky Elming
Jolene Fadiga
Farm Tough Hockey
Patricia and James Floersch
Patricia Flynn
Phyllis Foland

Barbara Fry
Gallagher, Bassett International Executive Team
Rebecca and Richard Gernant
Karen Gore
Siri Linn Granberg
Carol and Ronald Green
Donna and Kevin Greenland
Tammy and Dave Gregory
Kathryn Griffin
Glenda and Mike Gross
Kristina and Adam Grubb
Kyle Guldenpfennig
Seema Harichand-Herd
Twila Haviland
Carole and Ronald Heck
Le Ann Heitkamp
Nancy Hill
Elaine and Tim Hoffman
Amy Hopkins
Deborah and Michael Hubbell
Richard Hudson
Amy Hughes
Pamela Hyde
Susan Iiams
ILC Resources
Infinity Group LLC
JoDayle Irvin
Isaacson-Syerson Consulting
Jabil PMO Team
Scott E. Johnson and Michael D. Kunzler
Sue Kemmerer
David and Lola Kenworthy
Susan Killgore
Marvin Kister
Rachel Klingston
Kathy and Ron Klipfel
Knoxville Hospital & Clinic
Melissa and Zach Knutson
Nita and Leon Koenen
Laurie Konrad
Roger D. Kunz
Dennis Kuyper
Mike LaMair

Sara Lambert
Landoll Company, LLC
Mike and Mary Lane
Melanie Lane
Ingrid Larsen
Sheila Laubenthal-Black
Tonya Logsdon
Brittany and Andrew Long
Sandra and Robert Loughman
Brent and Angie Macke
LaRue and Robert Maddox
Nicholas Mancuso
Lola Mann
Lindy Markeson
Rick Mathews
Connie Maxson
Stephanie McAdam
Tim and Karla McCarthy
Theresa McCarty
M. Dennis McClure
Linda McCoy
Ralph McEldowney
Stephen and Sheila McGoldrick
Katie McIntyre
Michael L. McKinney and Kim Reynolds
Jason Medick
David Melz
Amy Mills and Jim Gilliam
Polly Moore
Ashley Mori
Shawn Mori
Tom and Shonda Mouser
Mary Murphy
Annette Nelson
Raymond Nelson
Crystal Nelson-Nield
Judy Nepple
NeuBridg, Inc
Sarah and Shawn Nigg
Sharon Norris
Julie Oestreich
Lisa Ohlinger
Osmundson Manufacturing Company

Gail and Mike Pace
Julie Paetow
Karen Page
Brian Perkins
Diane M. Pickle
Rebecca Poblete
Rev. David J. Polich
Chad Ranck
RCL Class of 2004
Chip and Dana Readinger
Jean Richmond
Linda Rick
Ryan Ross
Michael and Kim Routh
Linda and Paul Rye
Ruth Sanson
Eloise Scarpino
Carl Schieffelbein
Rebecca Schoonover
Lynn M. Schreder and Andrea Garland
Karla Schumacher
Stacy Schwarte
Vicky L. Seals
Troy Senter
Linda Shelburg
Jeana Shepherd
Mary Shotwell
Judd and Cynthia Shumaker
Gary Siddens
Sioux City Police Officer Association
Margie and Dave Spencer
Melissa Starr
Barbara and Jerry Stephens
Allan Stokes
Terri and George Storm
Clara Stults
Superior Auto Sales
Katie Swink
Syverson, Strege and Company
Laura Tallmon
Beckie Tanner-Devries
Ann Tharp
Patricia Trent

James and Kristin Troy
United Church of Christ Women's Fellowship
United Methodist Women
United Way Suncoast
Volunteers of America of Florida
Sharon Wallace
Mark and Cindy Watson
Bart and Jody Weller
Willis Auto Campus
Kathy and Greg Wilson
Kyla and Shawn Wilson
Sue Wilson
Windsor Presbyterian Church
Ralph Wingert
Pat Winters
Maria Wittern
Roxanne and Kevin Wood
Ferneitta Woodall
Woodmen Life Iowa Chapter 18
Evelyn and Randy Worth

Memorial Gifts Gifts totaling \$250 or more were given in memory of:

Patti Albert
Margaret J. Albrecht
James R. Anderson
Karen K. Anderson
Charlene Annis
Joan Arnold
Harry Atkinson
Connie Bailey
Janet Bailey
Richard D. Baker
Larry D. Baldosier
Conoley Ballard
Richard L. Ballew
Kevin Barker
Deloris M. Bengé
Helen Bjorklund
Nance J. Bloedow
James R. Bodensteiner
Connie K. Bodtke
LeAnn Boehne

Carol Bohner
Robert Boudewyns
Elizabeth Boulton
Virginia Boyd
Hubert F. Bradley
Gary Brake
Keith Brockway
Robert D. Brooks
Carolyn Brown
Kenneth Brown
Wanda Brown
Kathy Browns
Mary Kay Bruce
Mary M. Bubbs
Don M. Burgan
Tom Burkhardt
Lucille Campbell
Betty L. Canby
Phyllis Carpenter
Carol J. Clarke
Pauline Clubb
David E. Cormaney
Carol Cortesio
Donald Cowen
Ned L. Cox
Kelisa Cress
Betty Crittenden
Glenna Dabney
Erma Damewood
Charlotte J. Damman
Paul G. Daniels
Jonathan Dassinger
Carol A. Davis
Maxine Davisson
Ronald D. Day
Kolene K. Delaney
David Denney
Joyce Deuser
John R. Dibel
Judy Dillenburg
Gary Doolittle
Doris B. Drake
Robert Drake
Shirley Dresback
Kenneth G. Duncan

Christopher E. Dykes
Gary Eastridge
Jimmy Epperson
Jerry D. Ewalt
Elwood W. Ewing
Roberta Fadiga
Richard Farner
Carol Ann Fatino
Linda Fear
Diane and Jimmy Flahive
Donald D. Flynn
Joyce Fowler
Nicholas R. Fraizer
Lorraine Frame
Eldon R. Gammell
Lyle Gillette
Roger Gladfelder
Alden Godwin
Larry Good
Roberta M. Goodman
Max E. Greenland
Ellen E. Gregory
Michael L. Griffin
Lois Grout
Franklin J. Hardy
Johny Harper
Rose A. Harrington
Morris K. Harvey
Ralph Hedrick
Harold Hemphill
James Hoch
Mary Hogue
Yvonne B. Hollenbeck
Alan 'Joe' Hoover
Gloria Hudson
Glenna Huff
Barbara Irish
Richard Irvin
Molly Ivins
Lincoln W. Jackson
Bertha M. Jezek
Robert Johansen
Gary A. Johnson
Mary Johnson
Beverly J. Kanak

Janace Kaster
N. Thresa Kelly
Doris Key
Rebecca Kingery
Barbara Klingston
Warren C. Kruse
Sharon M. Kunz
Barbara Kuyper
Naomi Lacey
Marvin Lane
Brandon Laubenthal
Richard Laubenthal
Todd Lilienthal
Garold Lindley
Neva Long
James Longcor
Roberta Lucas
Leigh A. Lussie
Jack Manning
Alberta Mart
Lesteretta Mathews
Leon W. Maxson
Cathryn J. McBee
Lucille McCabe
Colleen McCall
Mildred McClavy
Gloria McClure
Charles McCoy
William McDanel
Linda L. McDowell
Ronald McDowell
Calvin McGhee
Agnes McLaughlin
Kenny Mehrhoff
Jim Mercer
Dan Mertens
Ann Mescher
Christine Mihalovich
Juanita Mills
Steve Mitchell
Verlyn Moats
Michael M. Moeller
Bernice Mooers
Thelma Moon
Nancy J. Morrison

Arleta Mullin
Jim Murrell
Brian Nappe
Irma Neil
Dennis C. Nellor
Kim Nelson
Peggy G. Nelson
Raymond E. Nelson
LeRoy Nepple
Betty Nixon
Sharon Norton
Mary Olive
John F. Overholtzer
Edwin L. Pace
Thomas E. Pearson
Paul D. Perkins
Shirley M. Peterson
Mary E. Pickle
Keith Pohl
James R. Porter
Mary Purvis
Myrna Quam
Charles H. Quayle
Vickie Randolph
William Ranes
Sharon Kay Rapalje
Roger L. Rasmussen
Shirley J. Rayl
Dorman Reed
Patricia Reed
Charles E. Richards
Janet Richardson
Ronald Richmond
Phyllis N. Riggs
Steve Roberts
Joann Robertson
Mary L. Rolfes
Myers Rossiter
Thelma L. Roth-Curry
Patricia Roux
Eunice Ruggles
Helen Rush
Eva M. Sampson
Keith R. Sawyers
Bernard Saylor

Robert Scarpino
Lyle Scheel
Theodore A. Schinstock
Roger Schoonover
Arnie Schraan
Glendora Schuldt
Helen Schwartz
Carl Seiberling
Paul and Avis Senter
Doris Sharp
Janet Shumaker
Gary L. Siddens
Charmion Sloan
Caroline Ruth Smith
Jeannie M. Snyder
Bonnie Sparks
Grace L. Squaires
Curtiss Stamps
Harold Steele
Iona Steffens
Darrell L. Stonehocker
Ted D. Stoner
David Stout
Rick Stowers
Nancy B. Strother
Amy Sunderland-Kleene
Mary L. Susin
Joyce B. Taber
Don F. Taft
Betty Talbot
Olive J. Tarbell
Jim D. Thomas
Eileen Tjernagel
Merle Trent
Beverly J. Trissel
Theodore Tussing
Thomas N. Urban
Robert Vance
Kathy Vander Tuig
Rich Waddingham
John J. Wadle
Jack A. Walker
Elleen E. Wheatley
Maxine White
Randel D. White

Helen Wiant
Marlene Wiese
Harold Williams
Ruth Willits
Jeannine Wingert
Linda Witt
Robert Woodall
Ann M. Wright
Joel E. Wuthrich

With your help, the EveryStep Foundation provided more than **\$2.5 million** in support to patients, clients and programs to ensure quality care for all — to help those without means to pay for their services, to provide end-of-life wishes, to help families with basic needs, and for operations support.

Thank You!

Kavanagh House *Our Future and Legacy*

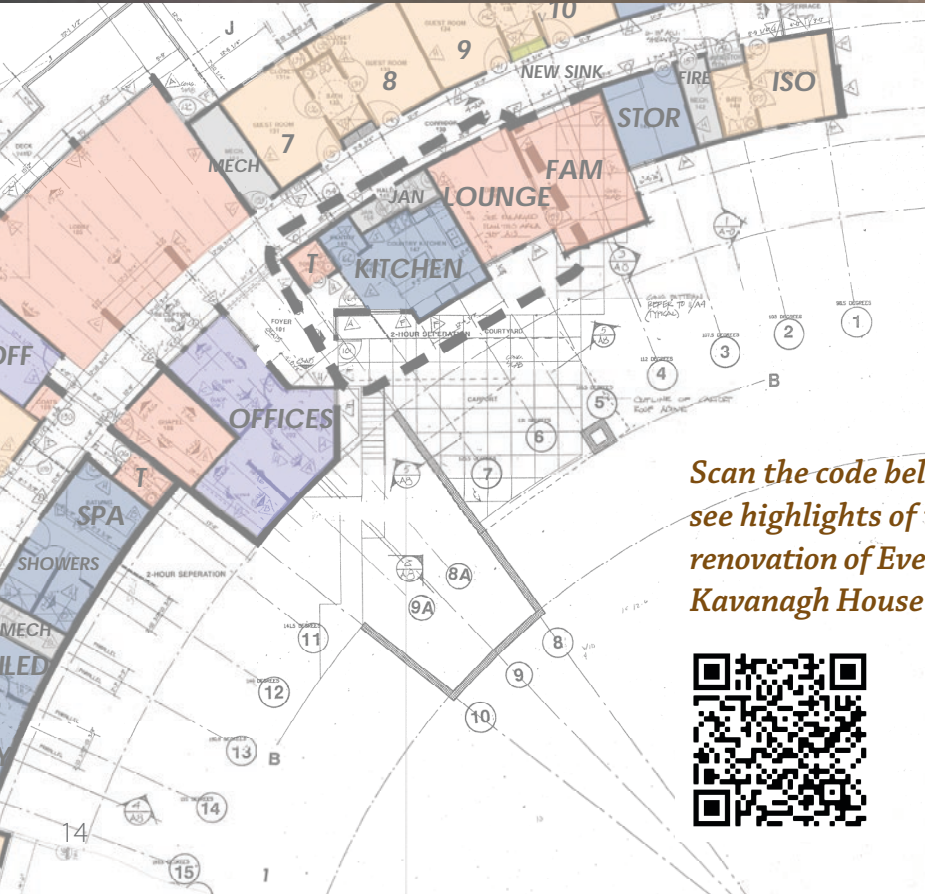

In 2019, the Board of Trustees launched a \$3.5 million capital campaign to restore, renovate and upgrade EveryStep's Kavanagh House hospice facility at 900 56th Street in Des Moines. We are grateful to the many donors who made the campaign a success and a renovated Kavanagh House a reality.

The following list reflects gifts and pledges made to the capital campaign from July 1, 2019 – November 15, 2021.

Scan the code below to see highlights of the renovation of EveryStep's Kavanagh House.



\$500,000+

Mary Kay and Douglas G Bruce
Suzie Glazer Burt

\$100,000 – \$499,999

Anonymous
W.T. and Edna M. Dahl Trust
The Graham Group, Inc.
Homesteaders Life Company
The John Ruan Foundation

\$50,000 – \$99,999

Sheri Avis Horner
Barbara and John Graham
Charlotte and Fred Hubbell
William C. Knapp Charitable
Foundation
Deb and George Milligan
Prairie Meadows
The Schaaf Family
Kim and Rich Willis

\$25,000 – \$49,999

Chris Benda
Berkshire Hathaway Energy
Graham Cook and
Catherine Bennett
Patty and Jim Cownie
Charitable Fund
Craig and Judy Hansen
Dee and Nick Henderson
Holmes Murphy
Dan and Joanie Houston
Linda and Tom Koehn
Merchants Bonding Company
Foundation
Meredith Corporation
Deb and Bob Pulver Foundation
Storey Kenworthy Foundation
for Giving
Phil and Amanda Stover
Kenneth and Katherine Waller
West Bank
Larry and Kathi Zimpleman

\$10,000 – \$24,999

Kerry and Denise Adaway
American Enterprise Group, Inc.
BJ and Tiffany Baker
Patricia Barry and Bryan Hall
Kim & Sally Beisser
The Coons Foundation
Graham Construction Company
Kemalyn and Edward Green
Chris and Denise Gunnare
John and Lisa Kenworthy
Foundation
Bill Knapp II and Gerry Neugent
Cathy and Steve Lacy
McAninch Corporation
Meredith Corporation
Matching Gifts
O'Donnell and Friends Charities
Debbie and Doug Reichardt
Sammons Financial Group
SHYFT Collection
Tray and Stacey Wade
Eric and Liliana Waters

\$5,000 – \$9,999

Anonymous
Mollie and Britt Baker
David and Cynthia Bridgewater
Mary C. Brooks
Allison and Jim Fleming
Threase Harms and
Rick Wagaman
Gary and Patricia Hoff
Connie and Richard Isaacson
Scott E. Johnson and
Michael D. Kunzler
Bruce and Susy Kelley
Jim and Cathy Knoepfler
Melissa and Zach Knutson
Chris and Peggy Littlefield
Julie and Harry Matternas
Trudy McCormick
Judith Milligan
Tom and Shonda Mouser
William J. Noth

John and Amy Pittman
Keith R. Sawyers
Pam and Chuck Schoffner
Larry and Chris Sidwell
Julie and Thomas Swank
Leann Thrapp
James and Kathryn Turner
William and Amanda Warner
Warren Wilson

Up to \$1,000 – \$4,999

Lori and Tom Bailey
Mark and Donna Beerman
Sarah and Craig Black
Lisa Bussard
H. Kennard Bussard
Kelly Caldbeck and Ted Thoms
Jeff and Peggy Carpenter
Jeff and Rhonda Cash
Basil and Linda Dawson
Sharon Dee
Jennifer and John Dilley
Rebecca and James Ervin
The Finway Group
Jane and Steve Flanagan
Dr. Brian Freeman
John and Ann Ghrist Foundation
Cara and Ryan Hannam
Mark and Kristi Hasek
Chris and Stacey Haviland
Debra Hayes
Diane and Jim Hedden
Charlie and Ron Kiesling
Gary and Joan Kirke
Shery and Terry Lint
Celia and Thomas Mahoney
Stephen and Sheila McGoldrick
Lynn and Catherine Michl
Kathy and Roger Morrison
Sandhya and Amar Nath
William Newland
John and Shari Paule
Principal Financial Group
Sally and Thomas Reavely
Kathy and Charles Safris

John and Judith Ann Schneller
Linda and Bruce Simonton
Mary Stuart and David Yepsen
Richard and Bonnie Sunderland
Thomas Temple
Ann and Rob Torry
Catherine Van Kley
Jim and Dee Vickery
Brian Walsh
Connie Wimer

Up to \$999

Anonymous
Linda Alexandres
Jennifer Anderegg
Jeanne Anderson
Joan Anderson
Rachon Aunspach
Bill and Pat Baehr
Nancy Baltazar
Carol Benedict
Diane Benoit
Janice and Bill Blackburn
Dolores Boehmke
Beth and Mark Brauer
Mike and Patricia Breen
Julie and Richard Bright
Wanda Brown
Kimberly and Mike Bryan
Ellen Bullington
Donald Bustell
Janet Christians
Adam and Megan Claypool
Maxine Clemens
Jo Ann Collins
Mary Conry
Jeffrey Couch
Dixie J. Daggett
Lori Danielson
Joyce and Floyd Fischer
Lois Gambill
Tom W. George
Jane Gillespie
Siri Linn Granberg
Roger and Barbara Grefe

Kathryn Griffin
Ronald and Beverly Halbrook
Janelle Hall
Brent and Mary Hanna
Jeff Hatfield
Mary Beth and David Hedding
Le Ann Heitkamp
Arthur Hessburg
Sue Hough
Nancy Howard
Phyllis Hoy
Sharon Hulen
Kathryn Hymans-Smith
Deanna Jackson
Donna Johnson
John and Barbara Kalianov
Marie Kayser
Casey and Cheryl Kazebeer
Yvonne Kelly
Gary Kinney
Kent and Theresa Klein
Sandy Klever
Brian Kramer
Roger D. Kunz
Mike LaMair
Carolyn and Steven Looney
Jeanne and John MacDonald
Laura and Marty Martin
Gary McBee
Charity and Bob Andeweg
Duane N. McCloskey
Pam McDowell
John G. McMichael
Brian and Stephani Moon
Kevin and Julie Moon
Polly Moore
Helen Moskal
Rosemary Neel
Lanette Nelson
Paula O'Donoghue
Jim O'Hare
Mary Oothout
Pamela Patton
Jack Payne
Gerald and Sharon Payton

Alison and Mitch Pick
David and Sharon Loring
Pommer
Barbara Pottorff
Jo Rhinehart
Pam Riley
Jacquelyn Roberts
Cheryl and Harold Rosen
Ava Roth-Collins
Dean and Marjorie Rowland
Rosemary Rutledge
Teresa and Dennis Schaffer
Sara Schlievert
Johanna S. Schmitt
Karla Schumacher
Sara J. Sersland
Caryl Shepherd
Luana Shull
Floyd Simmerman
Ann Spicer
Tammy Stapp
Allan Stokes
Green Stone
Leah Swartz Kaplan
Sharon and Donald Swim
Darby and Chad Taylor
Daniel Tvedt
Elaine Usher
Susan and Carl Voss
Jean Walker
Dorothy Waters-McAlister
Anne Webber
Bart and Jody Weller
Debbie Wheeler
Dick and Judy Wilderman
Dee A. Willemsen
Lucille Wilson
Elma Wright

Financials

REVENUE

Medicare/Medicaid	\$17,505,867	50.8%
Government Grants	\$7,031,934	20.4%
Investment Income & Gains	\$3,382,650	9.8%
Private Insurance	\$2,600,792	7.6%
Foundation Contributions	\$2,560,297	7.4%
Private Pay	\$1,286,331	3.7%
Other	\$74,958	0.2%
TOTAL*	\$34,442,829	

EXPENSES

Programs and Patient Support	\$26,450,380	80.1%
Organizational	\$5,854,712	17.7%
Fundraising	\$736,245	2.2%
TOTAL	\$33,041,337	

CHARITABLE IMPACT

Innovative Aging Hospice, Home Care, Senior Companion Program	\$688,795	26.9%
Community & Family Advocacy	\$657,459	25.7%
Family Empowerment	\$645,561	25.2%
Grief and Loss	\$568,482	22.2%
TOTAL	\$2,560,297	

*The following one-time, non-sustainable sources of funding are not included in the revenue total or funding sources:

- CARES Act and other COVID relief programs totaling \$3,935,032. These funds helped maintain full employment for our staff during the year, as well as paid for additional PPE and other costs directly related to the pandemic.
- Capital campaign gifts and pledge payments totaling \$1,216,942 for the campaign to renovate EveryStep's Kavanagh House.

Support Our Non-Profit Mission

As a non-profit organization, EveryStep relies on the support of generous donors. Below are just a few of the ways you can help.



Fundraising Events

EveryStep holds several fundraising events each year. You can support these efforts by attending an event, becoming a sponsor or donating items for auctions and raffles. To learn more about our events, visit everystep.org/about/fundraising-events

Art of Compassion

April 26, 2022

Amazing FundRacer

May 14, 2022

Good Grief Golf Outing

June 14, 2022



Honor Your Loves Ones

Many people support EveryStep in a meaningful way while honoring their loved ones. Gifts are sometimes given on special occasions such as birthdays or anniversaries as a way of remembering or honoring a special person. You can even establish a recurring gift on a regular basis — either monthly, quarterly or annually.

Memorial gifts of \$1,000 or more are recognized on one of our memorial displays located at Kavanagh House and at each of our hospice offices. Contact EveryStep Foundation to learn more about memorial gifts.



EveryStep Giving Tree Thrift Store

Shop and discover high-quality clothing, furniture, décor and more at EveryStep Giving Tree, located at 3330 100th Street in Urbandale. Proceeds benefit patients and families served by EveryStep.

You can also provide support and help keep our showroom stocked by donating your gently-used items.

For more information, visit everystepgivingtree.org



Other Program Support

Your monetary donations also help us purchase items for programs such as:

Stork's Nest – This incentive-based program helps low-income parents earn much-needed baby items like cribs, car seat and diapers.

Cheer Box – More than 650 families will receive a box of 12 thoughtful gifts during the holidays following the loss a loved one.

Adopt-a-Family – At-risk families will receive gifts and household goods to help make the holidays brighter.

To learn more about how you can support EveryStep, contact our Foundation staff at **(515) 274-3400** or giving@everystep.org.

2020-2021 Board of Directors

Pat Barry, Chair
Judy Ralston-Hansen, Past Chair
Kathryn Turner, Secretary
Dave Bridgewater, Treasurer
Graham Cook
Jen Groos, MD
Chris Gunnare
Mark Hasek
Nick Henderson
John Paule
John Pittman
Sally Reavely
Steve Schaaf
Pam Schoffner
Phil Stover
Tom Temple
Bill Warner
Lil Waters
Lori Young

2021 Board of Trustees

Bill Warner, Chair
Kerry Adaway, Past Chair
Chris Benda, Treasurer
Deb Milligan, Secretary
Katie Adams
Billy Backer
Erin Bailey
Mary Kay Bruce
Kelly Caldbeck
Brandon Foldes
Renee Hamlen
Charlie Kiesling
Melissa Knutson
Jackie Rollow
Jen Stanbrough
Ann Torry
Kim Willis

Emeritus Board

Suzie Glazer Burt
Rosemary Hillman
Sister Eve Kavanagh



(800) 806-9934 | everystep.org



*Thank you for supporting the
compassionate care and support
offered by our more than 30 programs.*



Runner-up Best Non-Profit



WE HONOR VETERANS

